

12 SPARE PARTS LIST 13.4761.01

13.4761.01	A483/32/0.80-0.90/ULT/9.0/A		A483.0002.01		27/07/98
Item-No.		Pcs.	Description	Dimension	Field
[A38.0132]		1	MOTOR CELL	EXC. 3,0	A19
A38.1148		1	SHAFT		C27
A38.1207	->[A48.0206]	1	TENSIONER VALVE SHELL		A17
A38.1209	->[A48.0206]	1	VALVE BOLT		B17
A38.1215	->[A48.0208]	1	GUIDE RING		C21
A38.1216	->[A48.0208]	5	SUSTAINING RING		C21+
A38.1217	->[A48.0208]	1	GUIDE RING		D21
A38.1218	->[A48.0208]	1	VALVE PISTON		C22
A38.1219	->[A48.0208]	1	BRIDGE		B21
A38.1220	->[A48.0208]	1	VALVE LEVER		C22
A38.1351	* ->[A38.0132]	8	VANE		B20
A38.1352	->[A38.0132]	1	END PLATE		A19
A38.1374	->[A38.0132]	16	FELT		B20+
A38.1376	->[A38.0132]	1	ROTOR		B20
A38.1377	->[A38.0132]	1	COUPLING		A19
A38.1378	->[A38.0132]	1	DOWEL		A19
A38.2301	->[A38.0132]	1	END PLATE		B19
A38.2302	->[A38.0132]	1	JACKET		A19
A38.2308	->[A48.0207]	1	TENSION SHAFT		B29
A38.2310	*	1	TENSIONING WHEEL		C27
A38.2311		1	SPACER RING		D26
A38.2317		1	HOLDER		C10
A38.2318		1	SPACER RING		C27
A38.2319	->[A48.0208]	1	PINION		B23
A38.2320	->[A48.0208]	1	INTERMEDIATE WHEEL	1-2	B22
A41.2120	->[A48.0202]	1	ROD BAR BOLT		D10
A46.2117	->[A48.0202]	2	JAW PIN		C2
A46.2118	->[A48.0202]	4	FRONT TOGGLE LINK		A3
A46.2132	->[A48.0208]	1	LEVER SHAFT		C23
A46.2145	->[A48.0202]	4	LEVER BOLT		A3+
[A48.0202]		1	JAW ASSEMBLY	32/0,8-0,9	A4
[A48.0206]		1	CYLINDER BOTTOM		A13
[A48.0207]		1	INTERMEDIATE GEAR		A28
[A48.0208]		1	GEAR	1 60.8	A24
A48.1237	->[A48.0206]	1	SIEVE		B11
A48.2113	->[A48.0202]	2	SPACER BUSH		B4
A48.2120	*	1	CUTTER JACK		D6
A48.2132	->[A48.0202]	4	SCREW		A2+
A48.3102		1	CONNECTION PLATE		C6
A48.3104	*	1	CUTTER	32 MM	C5
A48.3105		1	COVER PLATE		A1
A48.3106		2	TONG GUIDE		D5+
A48.3107		1	PISTON PLATE		B8
A48.3108		1	DISK		B8
A48.3109		1	DIAPHRAGM		A8
A48.3110		1	SEAL PLATE		B11
A48.3111		1	CYLINDER COVER		A8
A48.3113	* ->[A48.0202]	4	CUTTING JAW	32X0.8-0.9	B2+
A48.3116	* ->[A48.0202]	4	NOTCHING KNIFE	32 MM	C2+
A48.3117	->[A48.0202]	1	PISTON ROD		D9
A48.3119	->[A48.0202]	1	DISTANCE SUPPORT		C3
A48.3121	->[A48.0202]	1	SIDE PLATE		B5

[] = Group

* = Wearing parts

13.4761.01	A483/32/0.80-0.90/ULT/9.0/A		A483.0002.01		27/07/98
Item-No.		Pcs.	Description	Dimension	Field
A48.3123	->[A48.0202]	1	SIDE PLATE		B1
[A48.3124]	->[A48.0206]	1	CYLINDER BOTTOM		B10
A48.3127	->[A48.0206]	1	VALVE STEM		B15
A48.3128	->[A48.0206]	1	EXHAUST RING		B15
A48.3129	->[A48.0206]	1	SUSTAINING RING		A14
A48.3130	->[A48.0206]	1	CYLINDER SLEEVE		B16
A48.3131	->[A48.0206]	1	END RING		B16
A48.3132	->[A48.0206]	1	LEVER BODY		C18
A48.3133	->[A48.0206]	1	LEVER SHAFT		C18
A48.3134	->[A48.0206]	1	TENSIONER VALVE LEVER		D18
A48.3136	->[A48.0206]	1	CATCH SHAFT		C16
A48.3137	->[A48.0206]	1	CATCH LEVER		C18
A48.3138	->[A48.0206]	1	PISTON ROD		B26
A48.3139	->[A48.0206]	1	SEALING PLUG		B26
A48.3140		1	FORK		C27
A48.3141		1	GIB		C9
A48.3142	->[A48.0206]	1	PISTON		B15
A48.3147	->[A48.0206]	1	SEALING VALVE LEVER		D17
A48.3148	->[A48.0206]	1	COVER DISK		B17
A48.3151	->[A48.0206]	1	VALVE PISTON		C15
A48.3152	->[A48.0206]	1	VALVE CYLINDER		C15
A48.3153	->[A48.0206]	1	VALVE RING		C15
A48.3154	->[A48.0206]	1	SUSTAINING RING		C16
A48.3155	->[A48.0206]	1	TAPPED RING		C16
A48.3156	->[A48.0206]	1	ADJUSTING SCREW		C17
A48.3157		1	JAW GUIDE		B11
A48.3158		1	JAW GUIDE		C10
A48.3201		1	PIVOT PIN		C26
A48.3202		1	CAM ARM		C26
A48.3203		1	FORK BOLT		D26
A48.3204	->[A48.3227]	1	END COVER		C25
A48.3205		1	GUARD-PLATE		D9
A48.3206		1	COUPLING		B30
A48.3207		1	SEAL PLATE		C11
A48.3208		1	MOTOR COVER		C19
A48.3209	*	1	SLIDE JAW		C11
A48.3211		1	STRAP STOP	32 MM	D10
A48.3213	*	1	TENSIONING BODY	32 MM	D11
A48.3214	->[A48.3225]	1	INTERMEDIATE GEAR BODY		C28
A48.3215	->[A48.3226]	1	INTERMEDIATE GEAR COVER		B30
A48.3216	->[A48.0207]	1	PINION		B29
[A48.3217]	->[A48.0208]	1	GEAR BODY		C23
A48.3218	->[A48.3217]	1	GEAR BODY		C22
[A48.3219]	->[A48.0208]	1	GEARING COVER		C24
A48.3220	->[A48.3219]	1	GEARING COVER		B24
A48.3221	->[A48.0208]	1	INTERMEDIATE WHEEL	2-3	B22
A48.3222	->[A48.0208]	1	SPUR WHEEL	3	C23
A48.3223	->[A48.0208]	1	LEVER BODY		D22
[A48.3225]	->[A48.0207]	1	INTERMEDIATE GEAR BODY		D28
[A48.3226]	->[A48.0207]	1	INTERMEDIATE GEAR COVER		C30
[A48.3227]		1	END COVER		B25
N1.1123		2	SCREW	M8 X 30	D8
N1.1169		1	SCREW	M5 X 60	C25
N1.1174		2	SCREW	M10 X 1 X 40	D11

[] = Group

* = Wearing parts

13.4761.01	A483/32/0.80-0.90/ULT/9.0/A		A483.0002.01			27/07/98
Item-No.		Pcs.	Description	Dimension	Field	
N1.1180		2	SCREW	M6 X 90	B19	
N1.1198		2	SCREW	M10 X 65	A1	
N1.1807		1	SCREW	M5 X 12	D10	
N1.1808		4	SCREW	M4 X 10	D8	
N1.1811		3	SCREW	M6 X 40	B21+	
N1.1813		2	SCREW	M5 X 16	C6+	
N1.1814	->[A48.0206]	2	SCREW	M5 X 25	C18	
N1.1814	->[A48.0207]	4	SCREW	M5 X 25	B30+	
N1.1814	->[A48.0208]	2	SCREW	M5 X 25	A24	
N1.1815		11	SCREW	M6 X 25	A8	
N1.1817	->[A48.0208]	4	SCREW	M5 X 40	B24	
N1.2108	->[A48.0202]	2	SOCKET COUNTERSUNK HEAD SCREW	M6 X 16	B1+	
N1.2114		1	SOCKET COUNTERSUNK HEAD SCREW	M10 X 40	B8	
N1.2212	->[A48.0208]	3	SOCKET COUNTERSUNK HEAD SCREW	M4 X 25	D22	
N1.5301	->[A48.0206]	1	RETAINING NUT	M6	A14	
N1.5302	->[A48.0206]	1	RETAINING NUT	M5	C18	
N1.5608	->[A48.0206]	1	SLOTTED ROUND NUT	M8 X 1	B28	
N1.6103	->[A48.0206]	1	WASHER	5.3 X 9.5 X 1	C18	
N1.6114	->[A48.0206]	1	WASHER	6,4 X 12,5 X 1,6	B15	
N1.6201		2	SPRING LOCK WASHER	M10	A1	
N1.6206		2	SPRING LOCK WASHER	M8	C8	
N1.6207		1	SPRING LOCK WASHER	M5	C25	
N1.6220		2	SPRING LOCK WASHER	M6	B19	
N1.6502		2	SAFETY WASHER	M10	D10	
N2.1125		4	SECURITY RING	E3.2	C27+	
N2.1219	->[A48.0206]	1	SECURITY RING	I34	B26	
N2.1701	->[A48.0206]	1	SECURITY RING	17 MM	B28	
N2.2109		2	PARALLEL PIN	8 M6 X 30	D11	
N2.2125		1	PARALLEL PIN	4 M6 X 20	C9	
N2.2155		2	PARALLEL PIN	5H6 X 70	C29	
N2.2164	->[A48.0202]	1	PARALLEL PIN	6 M6 X 40	C4	
N2.2172	->[A48.0207]	2	PARALLEL PIN	5M6 X 30	B29+	
N2.2174	->[A48.0208]	2	PARALLEL PIN	6M6 X 60	B23	
N2.2175		2	PARALLEL PIN	6M6 X 22	C5+	
N2.2175	->[A48.0208]	1	PARALLEL PIN	6M6 X 22	B23	
N2.2413	->[A38.0132]	1	DOWEL PIN	4 X 20 MM	A20	
N2.2445	->[A38.0132]	1	DOWEL PIN	2,5 X 6 MM	B19	
N2.3208	->[A48.0206]	1	WOODRUFF KEY	2 X 2,6 X 6,76	C17	
N2.4407	->[A48.0208]	4	RIVET	2 X 3	B22	
N2.4902		4	HAMMER HEAD BOLT	1,85 X 4,76	A9+	
N2.5160	->[A48.0208]	1	PRESSURE SPRING	1 X 12 X 26	B21	
N2.5161	->[A48.0206]	1	PRESSURE SPRING	1 X 12 X 20	A16	
N2.5176		1	PRESSURE SPRING	0.6 X 5.5 X 31	C10	
N2.5201		1	PRESSURE SPRING	4.5X74.5X195	A11	
N2.5202		1	PRESSURE SPRING	5X98X220	C8	
N2.5206	->[A48.0206]	1	PRESSURE SPRING	0,8 X 5,8 X 21	C16	
N2.5609		2	CUP SPRING	45X22.5X1.75	B20	
N2.5815	->[A48.0206]	1	TORSION SPRING		C18	
N3.1102	->[A48.3225]	1	BALL BEARING		B28	
N3.1109	->[A48.3217]	1	BALL BEARING		B22	
N3.1109	->[A48.3219]	1	BALL BEARING		B23	
N3.1123	->[A38.0132]	1	BALL BEARING		A20	
N3.1133	->[A38.0132]	1	BALL BEARING		B19	
N3.1144	->[A48.3217]	1	BALL BEARING		B22	

[] = Group

* = Wearing parts

13.4761.01	A483/32/0.80-0.90/ULT/9.0/A		A483.0002.01		27/07/98
Item-No.		Pcs.	Description	Dimension	Field
N3.1144	->[A48.3219]	1	BALL BEARING		B23
N3.1144	->[A48.3226]	1	BALL BEARING		B29
N3.1703	->[A48.0206]	1	BALL	5 MM.	C16
N3.1706	->[A48.0206]	1	BALL	15 MM	A16
N3.2322	->[A48.3217]	1	NEEDLE CASE		B20
N3.2322	->[A48.3219]	1	NEEDLE CASE		B24
N3.2323	->[A48.3217]	1	NEEDLE CASE		C20
N3.2323	->[A48.3219]	1	NEEDLE CASE		B24
N3.3130	->[A48.3226]	1	HEADED PRESS FIT BUSH		C29
N3.3140	->[A48.3225]	1	HEADED PRESS FIT BUSH		C28
N3.3141	->[A48.3227]	1	HEADED PRESS FIT BUSH		D26
N4.9138		1	LABEL	<<A483>>	C9
N4.9159		1	LABEL	<<CE>>	A9
N41.9128		1	ADHESIVE LABEL		A8
N41.9129		1	ADHESIVE LABEL		A8
N6.3207	->[A48.0208]	1	JOINT		B21
[N6.3405]	->[A48.0206]	1	PISTON PLATE		B28
N6.3504	->[N6.3405]	1	INNER PACKING	8.3X12.1X4	B28
N6.3509	->[N6.3405]	1	EXTERNAL PACKING RING	32	B28
N6.5133	->[A48.0206]	1	REDUCING COUPLING		A11
N6.5624	->[A48.0206]	1	ANGLE		A11
N6.6113	->[A48.0206]	1	PACKING RING	10 X 16 X 4.5	B28
N6.6117	->[A48.0208]	5	SEAL	6 X 13 X 2.3	C21+
N6.6120	->[A48.0206]	1	SEAL	16 X 9 X 2.3	C14
N6.6121	->[A48.0206]	1	SEAL	8 X 15 X 2.3	B17
N6.6122	->[A48.0206]	1	SEAL	20 X 13 X 2.3	B16
N6.6146	->[A48.0206]	1	SEAL	15 X 22 X 2.3	B16
N6.6147	->[A48.0206]	2	SEAL	10 X 17 X 2.3	C15+
N6.6148	->[A48.0206]	1	SEAL	18 X 25 X 4.5	B14
N6.6202		1	O-RING	25 X 2,5	C27
N6.6204	->[A48.0206]	5	O-RING	18 X 2	A16+
N6.6210	->[A48.0206]	1	O-RING	30 X 2	B26
N6.6213		1	O-RING	20 X 2	D27
N6.6217	->[A48.0208]	7	O-RING	15 X 2	B21+
N6.6223		1	O-RING	50 X 2	A20
N6.6233	->[A48.0206]	1	O-RING	6 X 2	A20
N6.6235	->[A48.0206]	1	O-RING	12 X 2	B17
N6.6241	->[A38.0132]	2	O-RING	46 X 2	B19
N6.6255	->[A48.0206]	4	O-RING	21 X 2	A14+
N6.6255	->[A48.0207]	1	O-RING	21 X 2	B29
N6.6803	->[A48.3217]	1	PACKING RING	10 X 19 X 9.8	B20
N7.1106	->[A48.3225]	1	BUSH		C27
N7.1106	->[A48.3227]	1	BUSH		D26
N7.1204	->[A48.3227]	2	SEALING DISK		D25
N7.1205	->[A48.3226]	1	SEALING DISK		C30

[] = Group

* = Wearing parts

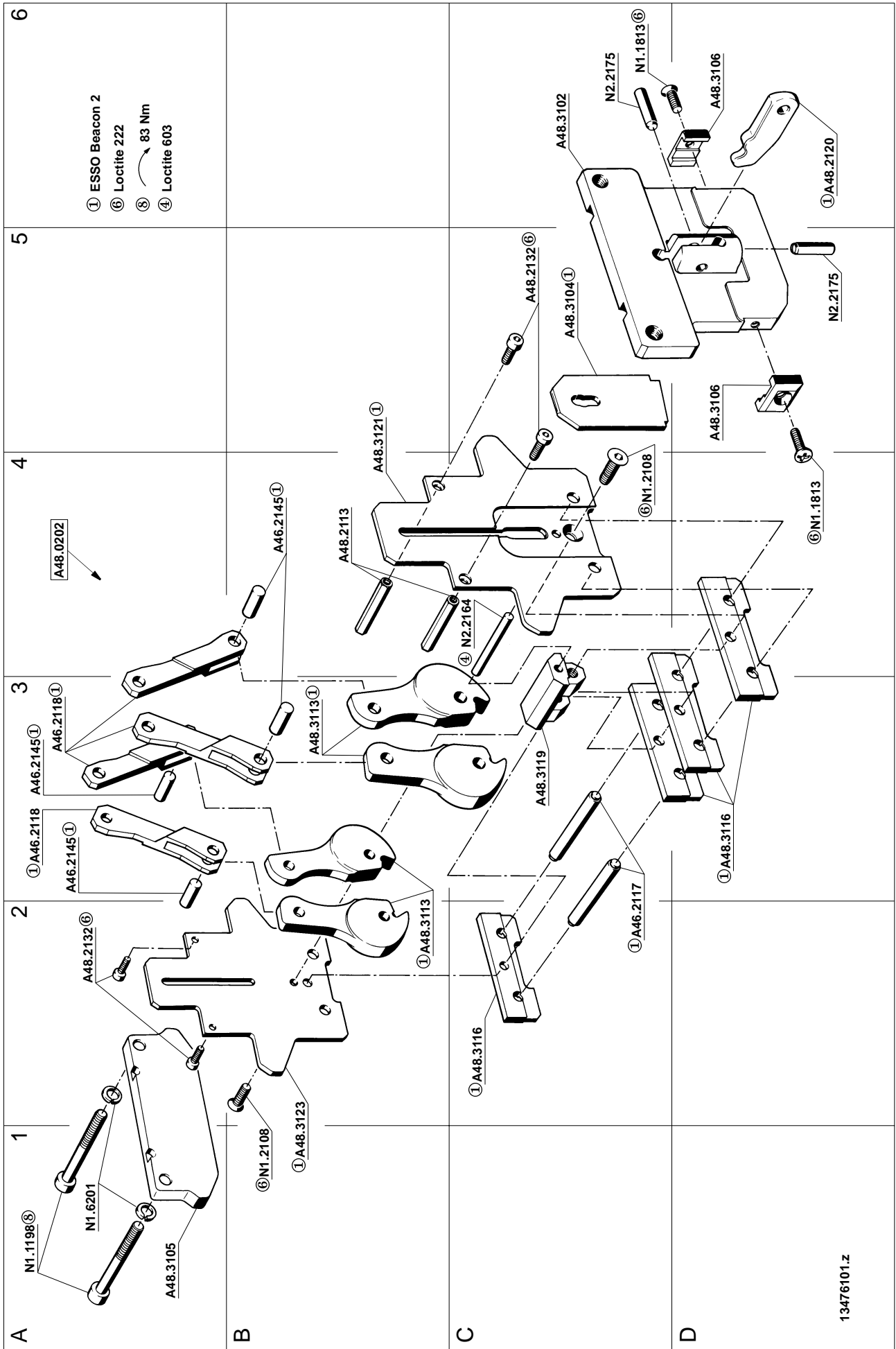

13476101.Z

